

PARTS for 30 and 55 Gallon Units

Part No.	PARTS	Part No.	PARTS
610	Air Line Coupling	655	Gasket for 30-Gallon Cover
627-3	Venturi Box Mounting Hardware <i>(set)</i>	656	Gasket for 55-Gallon Cover
628-3	Exhaust Housing Mounting Hardware <i>(set)</i>	660-3	Retaining Spring <i>(set of 3)</i>
634-3	Elbow Mounting Hardware <i>(set)</i>	664	Elbow Gasket
635	Internal Filter Assembly	680	Triangular Chamber for Dual-Venturi Model
635-PK	Package of Six p/n 635 Internal Filter Assemblies	681	Venturi Box
635-B	Cloth Internal Filter Bag	682	Gasket for Venturi Box
638	Liquid Shut-Off Assembly	685	Exhaust Housing
638-1	Float, only, for Liquid Shut-Off	685-C	End Cap, only, for Exhaust Housing
638-2	Cage, only, for Liquid Shut-Off	686	Exhaust Silencer <i>(foam insert)</i>
640	Cover, 30-Gallon Drum size	688	Gasket for Dual-Venturi Chamber
641	Cover, 55-Gallon Drum size	689-3	Mounting Hardware for Dual-Venturi Chamber <i>(set)</i>
644	Venturi for "B" Models	700	Inlet Elbow
644-D	Venturi for "D" Models	701	Discharge Elbow
646	Shut-Off Valve for Dual-Venturi Model	708-3	Inlet Air Manifold for Dual-Venturi Model
647	Air Line Coupling for Dual-Venturi Model	710	Extra-Silent Exhaust Assembly
648	Air Jet for "B" Models, with Bushing	711	Exhaust Silencer set, only, for No. 712 Housing
648-D	Air Jet for "D" Models, with Bushing	712	Extra-Silent Exhaust Housing, only
649	Bushing, only, for Air Jet	715	1-1/2" Hose Adapter
651	Shut-Off Valve	720	2" Hose Adapter

Part No.	Service Kits
MK-55	Maintenance Kit for 55-Gallon Models <i>Includes (1) p/n 635, (2) p/n 635-B, (1) p/n 686, and (1) p/n 656</i>
MK-30	Maintenance Kit for 30-Gallon Models <i>Includes (1) p/n 635, (2) p/n 635-B, (1) p/n 686, and (1) p/n 655</i>

For additional replacement hose and accessories, please refer to price sheets.

55 AND 30 GALLON VACUUM GENERATING HEADS

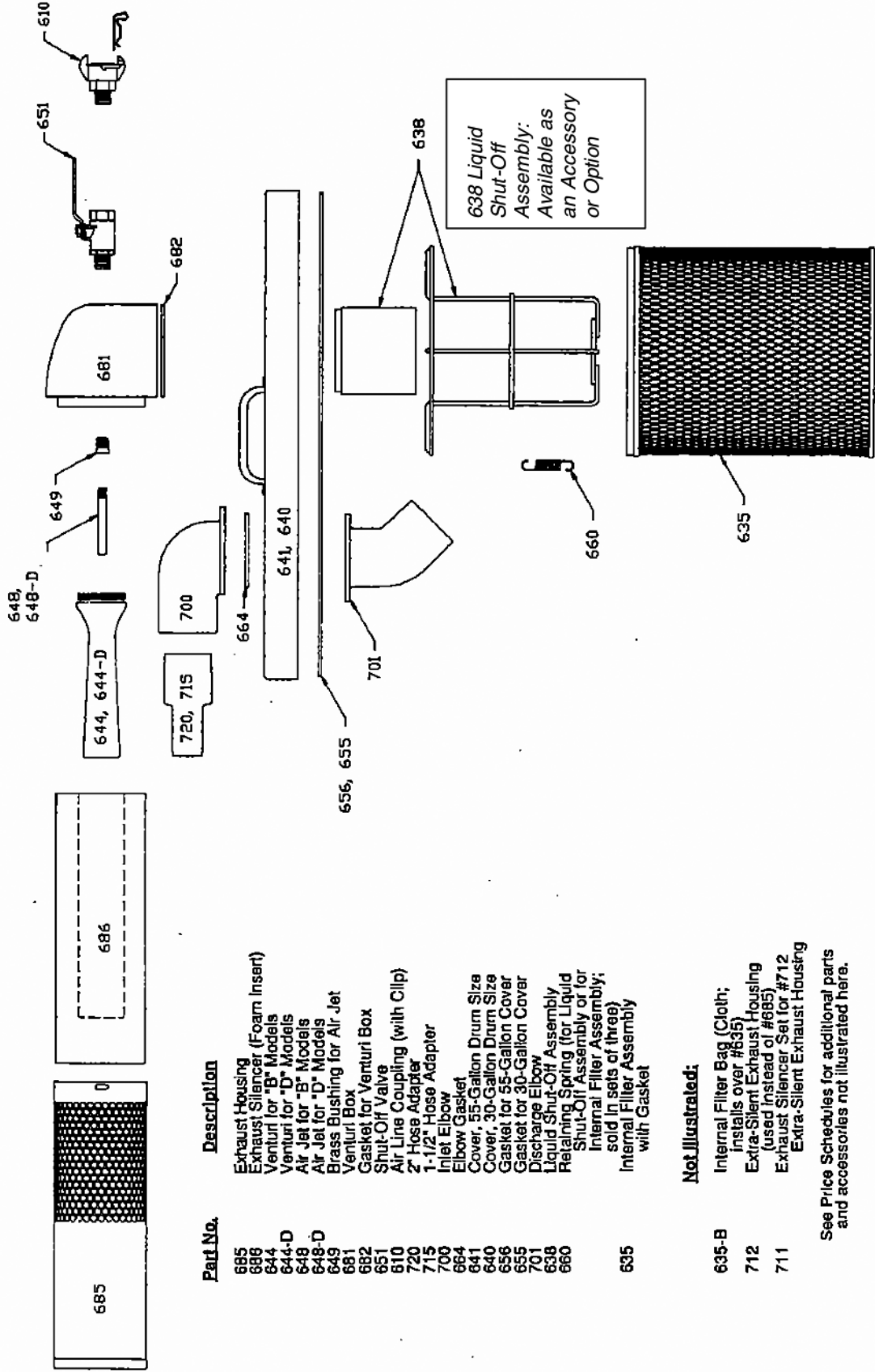

Part No.	Description
685	Exhaust Housing
686	Exhaust Silencer (Foam Insert)
644-D	Venturi for "B" Models
648-D	Venturi for "D" Models
649	Air Jet for "B" Models
651	Air Jet for "D" Models
681	Brass Bushing for Air Jet
700	Venturi Box
664	Gasket for Venturi Box
701	Shut-Off Valve
655	Air Line Coupling (with Clip)
720	2" Hose Adapter
715	1-1/2" Hose Adapter
709	Inlet Elbow
664	Elbow Gasket
641	Cover, 55-Gallon Drum Size
640	Cover, 30-Gallon Drum Size
656	Gasket for 55-Gallon Cover
655	Gasket for 30-Gallon Cover
701	Discharge Elbow
638	Liquid Shut-Off Assembly
660	Retaining Spring (for Liquid Shut-Off Assembly or for Internal Filter Assembly; sold in sets of three)
635	Internal Filter Assembly with Gasket

Not Illustrated:

- 635-B Internal Filter Bag (Cloth; installs over #635)
- 712 Extra-Silent Exhaust Housing (used instead of #685)
- 711 Exhaust Silencer Set for #712 Extra-Silent Exhaust Housing

See Price Schedules for additional parts and accessories not illustrated here.